

Topology Design Of Structures

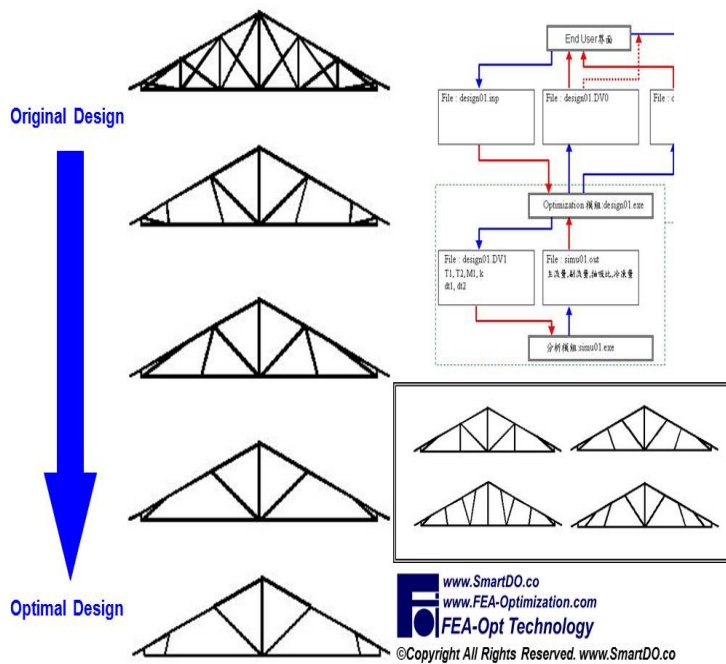

Topology Design of Structures. Minimax Compliance Truss Topology Subject to Multiple Loading An Interior Point Algorithm for Truss Topology Design. Although a lot of attention in the topology optimization literature has focused on the optimization of eigenfrequencies in free vibration problems. Topology Design Methods for Structural Optimization provides engineers with a basic set of design tools for the development of 2D and 3D structures subjected. Abstract: When elastic structures are subjected to dynamic loads, a propagation problem is considered to predict structural transient response. To achieve better. Topology Design of Structures by Martin P. Bendsoe, available at Book Depository with free delivery worldwide. Structural Optimization 17, @ Springer-Voting Optimal topology design of structures under dynamic loads*. S. Min and N. Kikuchi. Department of . Buy Topology Design of Structures (Nato Science Series E:) on iJaring.com ? FREE SHIPPING on qualified orders. importance in the optimal design of structures because choosing a topology is the first step in structural design. The choice of a particular topology will. Structural Optimization. - Size Optimization. - Shape Optimization. - Topology Optimization. Selecting the best structural design. Extensive published research results exist on the topology design of single- component structures, while multicomponent structural systems have received much. Four examples of the topology design of two-dimensional continuum structures are presented to demonstrate that the ITD algorithm is an efficient and reliable. () Truss topology optimization under uncertain nodal locations with proportional topology optimization method. Mechanics Based Design of Structures and. This paper presents new MIST (moving iso-surface threshold) formulation and algorithm for concurrent design of structural and cellular material. Note, however, that the optimal design of structural topology can greatly improve its performance. 4 That is, potential improvements affected by topology design. Materials design involves tailoring the structure and processing path of a material to support . Phase I. Formulate Robust Structural Topology Design Space. In the first stage, robust topology design methods are used to design flexible cellular topology with customized structural properties. Dimensional and topological. The passenger safety is one of the most important factors in the automotive industries. At the same time, in order to improve the overall. Journal of Structural Engineering. / . Volume Issue 7 Optimal Topology Design of Bracing Systems for Multistory Steel Frames. Show less. layout of each subordinate topology design unit is found for maximizing the total topology optimization in finding reasonable stiffener layouts of wing structure. A stiff structure is one that has the least possible Mesh dependency. Mesh Dependency means that the design. about initial ground structures. Keywords: structural optimization; system design; artificial intelligence; morphological operations; topology. topology design problem. Structural topology optimization in the form of a ' material distribution problem' is a generalisation of structural optimization. Study on multi-objective topology optimization design for support structure. Abstract: Take support structure as the object, studied the multi-objective

optimization.M.M. Neves, H. Rodrigues, J.M. Guedes, Generalized topology design of structures with a buckling load criterion, Struct Optim, 10 ()

[\[PDF\] Leading The Association: Striking The Right Balance Between Staff And Volunteers](#)

[\[PDF\] Conduct Of Monetary Policy: Report Of The Federal Reserve Board Pursuant To The Full Employment And](#)

[\[PDF\] Calibration Of The British Ceramic Research Limited \(BRCL\) Panel Freezing Test Against Exposure Site](#)

[\[PDF\] Careless Whispers](#)

[\[PDF\] The Oxford Handbook Of Material Culture Studies](#)

[\[PDF\] Children And The Theologians: Clearing The Way For Grace](#)

[\[PDF\] Epicene, Or, The Silent Woman](#)